

LEON CREEK WRC RAS PUMP STATION REPLACEMENT PROJECT

Pre-Bid Conference

January 11, 2017



Agenda

- Scope of Work
- Project Overview
- Special Conditions
- Questions

Scope of Work

- Demolition of existing six RAS Pump Station (PS) No. 2 pumps, including piping, swing check valves, knife gate valves, RAS pumps and non-potable water lines.
- Installation of six new pumps for RAS PS No. 2, including all appurtenances noted above.
- Replace six VFDs, including replacement of VFD enclosures.
- Install new power, instrumentation and controls for RAS PS No. 2 for the connections to existing PLC at Old Blower Building.
- Replace all lighting and wall outlet conduit wiring at RAS PS No. 2.
- Install new LED lighting and lighting contacts for RAS PS No. 2 structure.
- Install new wiring and controls for RAS PS No. 1 for the connections to the existing PLC at the Chlorine Building MCC room.
- System programming at RAS PS Nos. 1 and 2.

Project Overview – Site Plan



Project Overview – RAS PS No. 2



Project Overview – RAS PS No. 2 Demolition

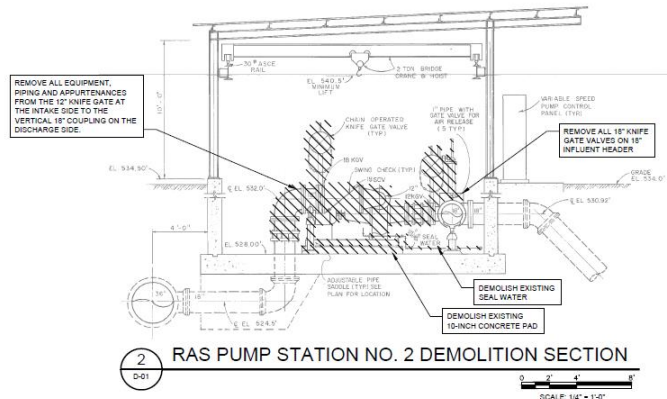
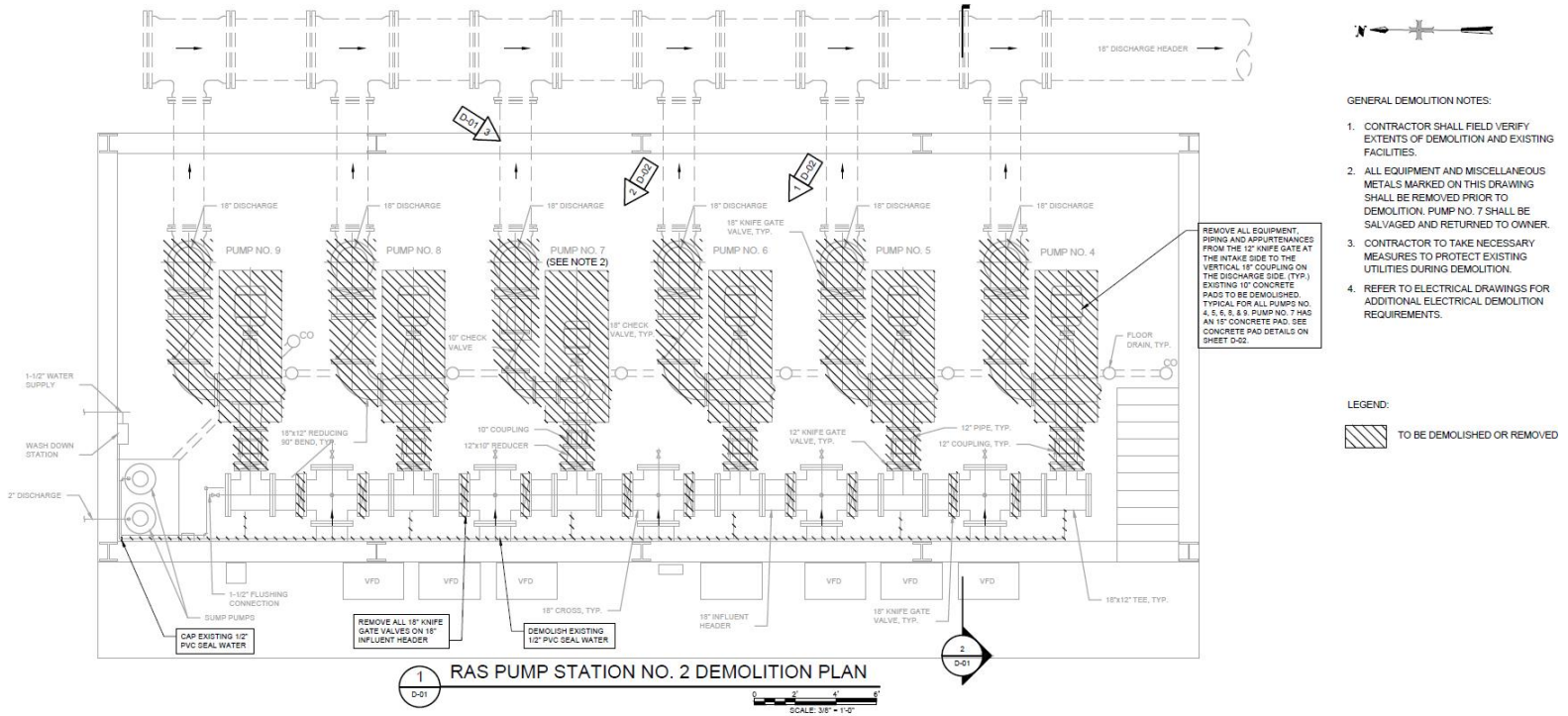

Project Overview – RAS PS No. 2 Demolition

LEGEND:

 TO BE DEMOLISHED OR REMOVED



REMOVE ALL EQUIPMENT, PIPING AND APPURTENANCES FROM THE 12" KNIFE GATE AT THE INTAKE SIDE TO THE VERTICAL 18" COUPLING ON THE DISCHARGE SIDE. TYPICAL FOR ALL PUMPS.



REMOVE ALL EQUIPMENT, PIPING AND APPURTENANCES FROM THE 12" KNIFE GATE AT THE INTAKE SIDE TO THE VERTICAL 18" COUPLING ON THE DISCHARGE SIDE. TYPICAL FOR ALL PUMPS.

EXISTING PUMP NO. 7 SHALL BE SALVAGED AND RETURNED TO OWNER.

DEMOLISH EXISTING 15-INCH AND 3.5-INCH CONCRETE PAD AT PUMP NO. 7. SEE SHEET S-01 FOR DETAIL.

1 RAS PUMP STATION NO. 2
D-02

2 RAS PUMP STATION NO. 2 - PUMP NO. 7
D-02

Project overview– RAS PS No. 2 Piping Plan

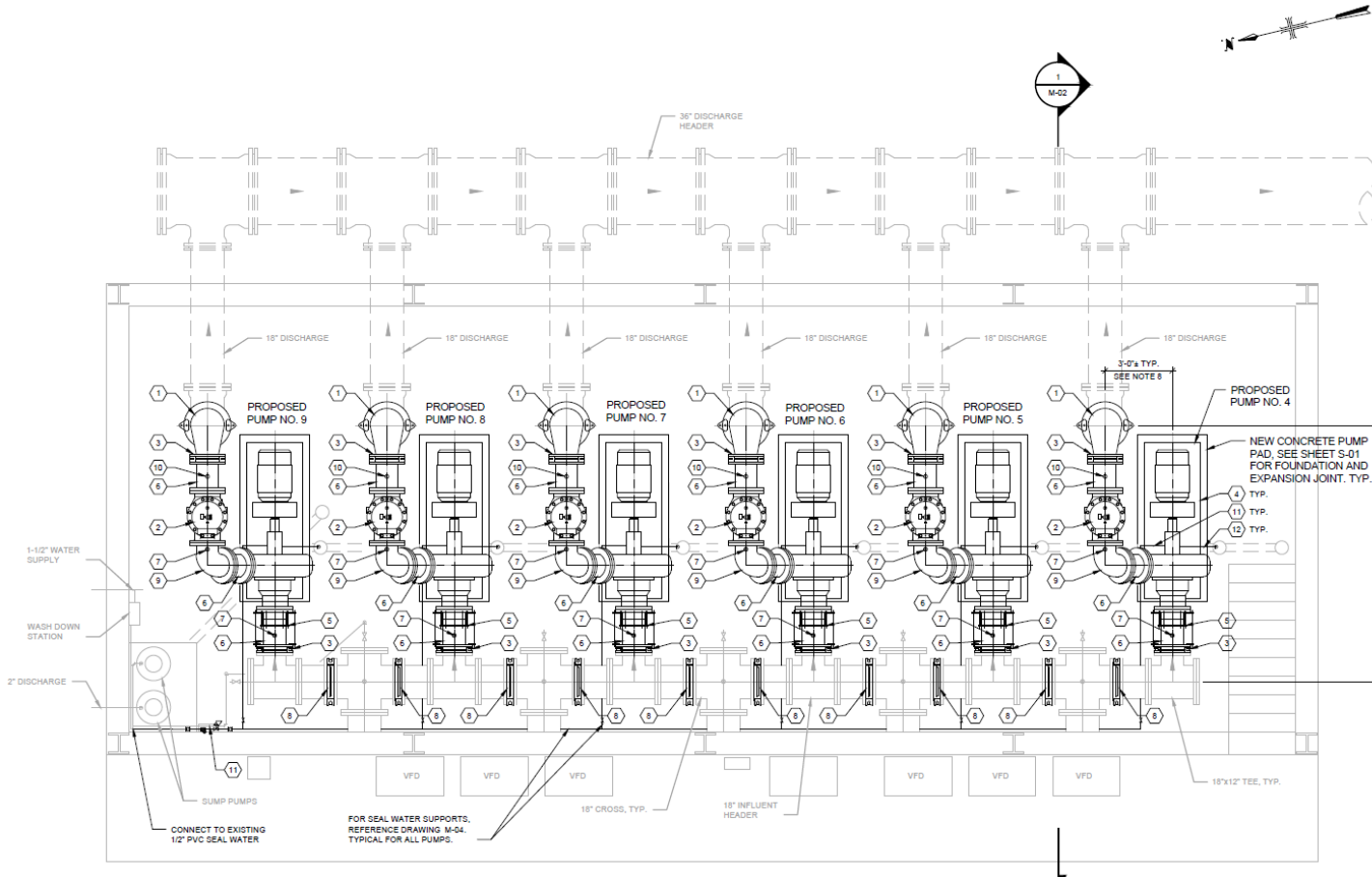

NOTES:

- ALL DIMENSIONS SHALL BE FIELD VERIFIED AND CONFIRMED BY EQUIPMENT SUPPLIER AND CONTRACTOR PRIOR TO MANUFACTURING AND CONSTRUCTION.
- ALL PIPING, VALVES, FITTINGS, ETC. TO BE COATED AND LINED IN ACCORDANCE WITH THE SPECIFICATIONS.
- LOCATION AND QUANTITY OF PIPE SUPPORTS TO BE DETERMINED BY CONTRACTOR PER SPECIFICATIONS.
- INSULATE ALL PIPING LESS THAN 4-INCHES, IN ACCORDANCE WITH SPECIFICATIONS.
- ALL PIPING SHALL BE INSTALLED SQUARE, LEVEL AND/OR PLUMB. NO JOINT DEFLECTION WILL BE ALLOWED ON ANY EXPOSED PIPE.
- CONTRACTOR SHALL PROVIDE TWO EXTRA 18" CERAMIC EPOXY LINED SPOOL PIECES FOR INSTALLATION BETWEEN CROSSES IF EXISTING ONES ARE FOUND TO BE DAMAGED DURING REPLACEMENT. SAWS SHALL RETAIN SPOOL PIECES IF FOUND TO NOT BE NEEDED.
- REUSE OF EXISTING BOLTS, WASHERS, NUTS, AND GASKETS WILL NOT BE PERMITTED FOR PIPING REPLACEMENT. CONTRACTOR SHALL HAVE ON-SITE THE NECESSARY NUMBER OF NEW 316SS BOLTS, NUTS, WASHERS AND NEW GASKETS FOR REPLACEMENT OF PIPING PRIOR TO BEGINNING REPLACEMENT.
- DIMENSIONS SHOWN FOR EXISTING PIPING ARE FOR BIDDING PURPOSES ONLY. CONTRACTOR MUST FIELD VERIFY ALL DIMENSIONS BEFORE ORDERING PUMPS, FITTINGS AND EQUIPMENT. PROPOSED PUMPS, PIPING, VALVES AND APPURTENANCES SHALL FIT WITH REQUIRED DIMENSIONS.

KEYNOTES * (X) *

- 18"x12" REDUCING 90° BEND, DIP, FLG.
- 12" CHECK VALVE
- 12" KNIFE GATE VALVE
- PUMP MOTOR BASE, SIZING PER MANUFACTURER.
- 12" RESTRAINED FLANGE COUPLING ADAPTER W/ S.S. RODS.
- 12" SPOOL PIECE
- PRESSURE GAUGE AND SWITCH, SEE DETAIL 3/M-03.
- 18" KNIFE GATE VALVE
- 12" 90° BEND, DIP, FLG.
- ADJUSTABLE PIPE SUPPORT, SEE DETAIL 1/M-03
- 12" NPW, PVC. CONNECTION SIZE PER MANUFACTURER RECOMMENDATIONS. SEE DETAIL 4/M-03.
- 12" PVC DRAIN LINE FROM PUMP PACKING GLAND DRAIN TO EXISTING FLOOR DRAINS. CONNECTION SIZE AND PACKING GLAND PER MANUFACTURER RECOMMENDATIONS.

1 RAS PUMP STATION NO. 2 PLAN

SCALE: 3/8" = 1'-0"

Special Conditions

- On RAS PS No. 2, remove all equipment, piping appurtenances from 12” knife gate valve at the intake side to the vertical 18” coupling on the discharge.
- Pump No. 7 of RAS PS No. 2 shall be salvaged and return to Owner.
- Existing VFDs of RAS PS No. 2 shall be salvaged and return to Owner.
- Follow sequencing of work suggestions included in Section 01 14 16 – Coordination with Owner’s Operations, if Contractor has a different sequencing suggestion it shall be submitted to Engineer for Approval.
- Contractor shall coordinate shutdowns with Owner and Engineer.

Special Conditions

- Contractor shall identify all underground tie-in locations/utility conflicts with proposed improvements.
- The project considers 3 allowances for: Permitting fees, Emerson Management Services and Pre-Startup/Commissioning Construction Items.
- Contractor shall follow Emerson contract documents, included in Project Manual. Emerson work includes engineering services for new HMI graphic screens to be created for remote monitoring and control of the existing RAS PS No. 1 and new RAS PS No. 2 pumps.

Questions?

- All questions shall be submitted in writing to SAWS.